

Mangawhai Water Supply

Meeting: Council Briefing
Date of meeting: 7 July 2021
Reporting officer: Jim Sephton, GM Infrastructure

Purpose | Ngā whāinga

To brief Council on emerging options regarding the supply of water to Mangawhai and seek any areas of concern which can be addressed through the investigation.

Context | Horopaki

Through the LTP deliberations (20 May 2021), Council recommended to 'approve funding \$100,000 in the district wide water rate for investigation into a possible water security option for Mangawhai'.

The focus of this investigation will be the extension of the Whangarei Water supply system to Mangawhai. This could be to connect to new reticulated systems provided by new developments or to create tank filling stations.

Council officers have subsequently been approached by Mangawhai Central Limited (MCL) to gauge support on a proposal to extend the water supply from Whangarei (Langs Beach) to Mangawhai.

It noted that there are no funds allocated to the creation of a water supply for Mangawhai in the 2021 Long Term Plan.

Plan Change 78,

A water reticulation network (including an onsite reservoir) is proposed as part of the PC78 development.

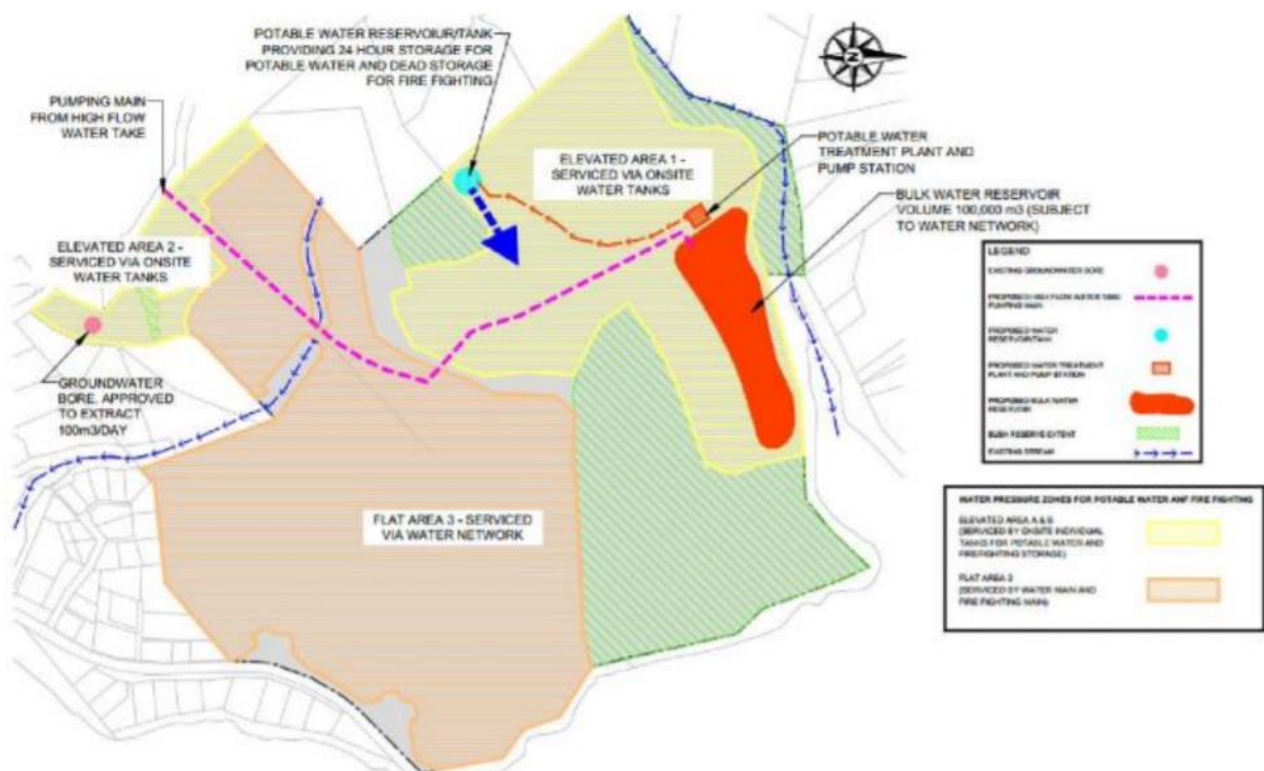

Any reticulation for the proposed development in PC78 would need to be funded and constructed by the developer to service development within the subject site

Discussion | Ngā kōrerorero

The offer from the developer(MCL) is to build the pipe from Langs Beach to MCL at its own cost. They have also offered to oversize the pipe from a 150mm to 250mm to future proof the capacity.

The initial proposition is that MCL would retain ownership of this infrastructure (pipe) however discussions are being developed regarding the most appropriate way forward. This could involve vesting in KDC or WDC.

The onsite infrastructure would be built and operated by MCL as a private water supplier.

WDC would effectively sell water to MCL who would then on sell to connected properties. It is likely that there would be some Infrastructure Charge for properties within Mangawhai Central.

Risk to Kaipara District Council

There is limited risk to KDC as we are neither supplying bulk water or undertaking the role of a private water supplier in this proposition.

MCL would be a utility provider and the works undertaken in the road corridor would be approved as per any other utility provider.

There is an opportunity to increase the security of water supply for Mangawhai through this proposition.

- The creation of tank filling facilities within Mangawhai Central
- The sizing of pipes to allow connections to future growth areas

Next steps | E whaiake nei

The developer is well progressed with their subdivision process as is requesting confirmation that WDC and KDC will support this proposal. They require a signed agreement by October to meet their construction timeframes.

From a commercial perspective there are many more implications for WDC to explore than KDC. There are additional costs to upgrade the system as well as revenue considerations including charging mechanisms.

The KDC investigation will focus on ensuring that the 'future proofing' of the system to accommodate future growth is incorporated. This will be primarily relating to pipe sizes but will also include potential reservoir and pump locations.

We would also engage with Iwi to understand their position.

WDC will need to consider the impacts of providing more water to Mangawhai against current and future demand in the Bream Bay corridor. There are other upgrades required to accommodate this cost which need to be explored and agreed.

A further paper will be brought to Council on completion of the above steps.